



RHINO-RACK

Aerodynamic & Heavy Duty Roof Rack Systems

RBP-CBM Rhino Beacon Plate Cabin Bar Mounted

Place these instructions in the vehicle's glove box after installation is complete.

Important: Please read these instructions carefully prior to installation. Please refer to your fitting instruction to ensure that the roof racks are installed in the correct locations. Check the contents of this kit before commencing fitment and report any discrepancies.

Parts List

Item	Component Name	Qty	Part No.
1	Beacon Plate	1	C574
2	M6 x 90 Security Screw	2	B097
3	M6 Washer x 16mm	2	W031
4	M6 Washer x 32mm	2	W029
5	M6 Nyloc Nut	2	N013
6	Security Key	1	H021
7	Instruction Manual	1	RS-319

Care Instruction:

Thoroughly clean vehicle head board prior to fitting beacon plate.

Tools Required

Electric Drill, 6mm Drill, Cold Gal (as required)

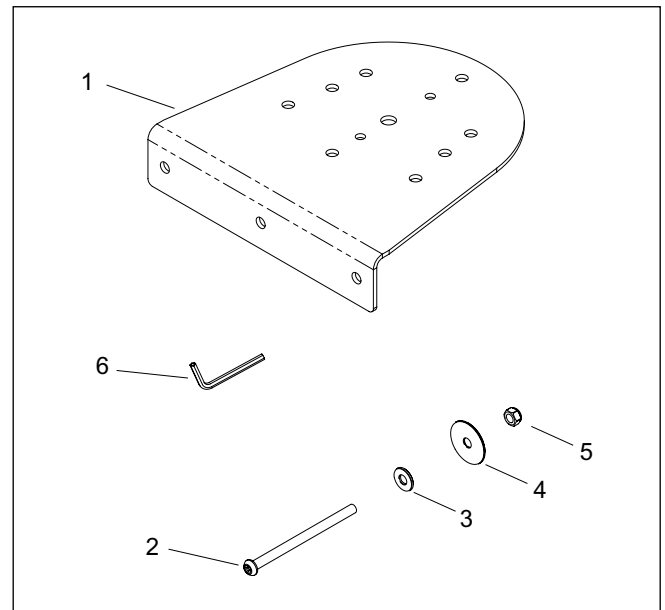

1 Mark position of Beacon Plate:

Hold the Beacon Plate in the desired location and mark its position by running a pencil or marker through the 2 outside mount holes in a circular direction.

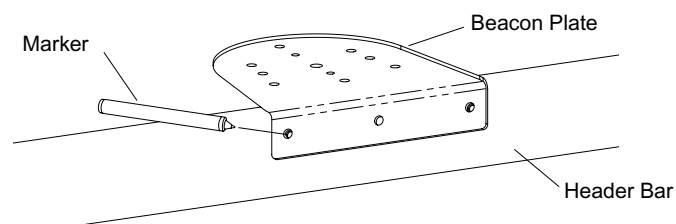

2 Drill Mount Holes:

Drill 2, 6mm holes through header bar where previously marked keeping your drill level to ensure a straight hole through the bar. If drilling through steel apply cold gal to holes after drilling.

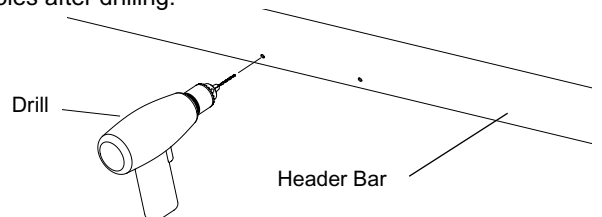

3 Fasten in Position:

Fasten Beacon Plate in position as detailed in below images.

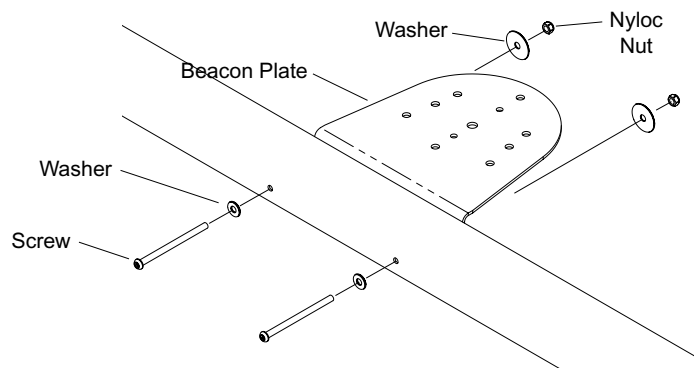
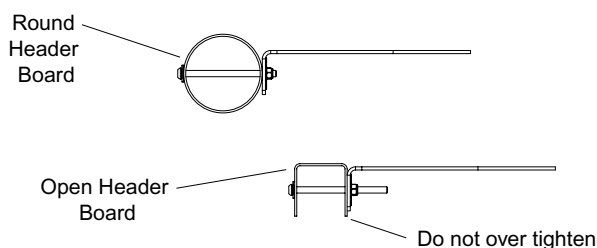

Important Information

Recommendations

It is essential that all bolt connections be checked after driving a short distance when you first install your Rhino Rack accessory. Bolt connections should be checked again at regular intervals (probably once a week is enough, depending on road conditions, usage, loads and distances travelled). You should also check the roof bars and accessories each time they are refitted.

Make sure to fasten your load securely. Please ensure that all loads are evenly distributed and that the centre of gravity is kept as low as possible.

Sensitivity to Crosswinds, Behaviour in Curves and Braking

The handling characteristics of the vehicle, changes when you transport a load on the roof. For safety reasons, we recommend you exercise extreme care when transporting wind-resisting loads; special consideration must be taken into account when braking.

Please remove crossbars when putting vehicle through an automatic car wash.

Load Ratings

Refer to vehicle manufactures carrying capacity for roof bars. When roof racks are to be used in off-road conditions, please build a safety factor of 1.5 into this load limit. Although the roof racks are tested and approved to AS1235-2000, Australian road conditions can be much more rigorous. However, increasing the number of crossbars does not increase the vehicles maximum permissible roof loading.

Note for Dealers and Fitters

It is your responsibility to ensure instructions are given to the end user or client

Rhino-Rack
3 Pike Street, Rydalmere,
NSW 2116, Australia.
(Ph) (02) 9638 4744
(Fax) (02) 9638 4822

Document No: RS-319
Prepared By: Nigel Greig
Authorised By: Gary England

Issue No: 01
Issue Date: 17/08/2007

These instructions remain the property of Rhino Rack Australia Pty Ltd and may not be used or changed for any other purpose than intended.