

SCALE 1.000

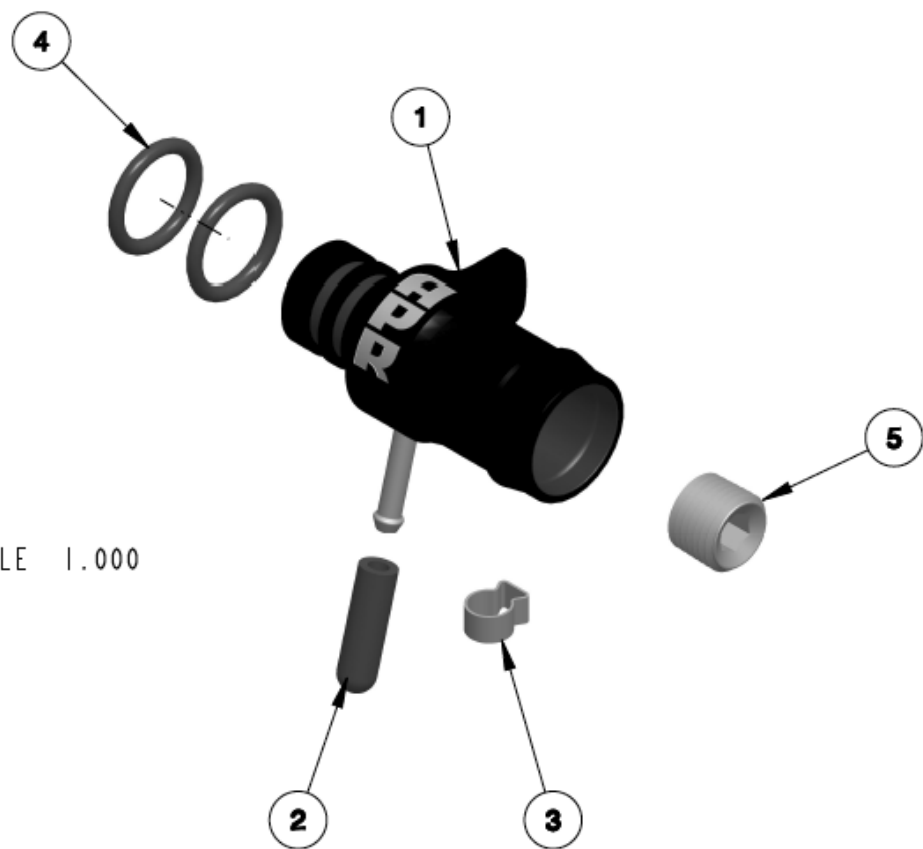

NOTES:

- 1. LUBRICATE O-RINGS, ITEM 4, WITH A MODERATE AMOUNT OF ENGINE OIL BEFORE INSTALLING**
- 2. TO INSTALL BOOST TAP, INSERT INTO PORT ON INTAKE MANIFOLD WITH TAB FACING MANIFOLD AT AN UPWARD ANGLE ABOVE THE WEBS ON MANIFOLD. PUSH AND TWIST SLIGHTLY UNTIL THE TAP SEATS FLUSH AGAINST THE END OF THE PORT, THEN ROTATE CLOCKWISE UNTIL THE TAB IS LOCKED BEHIND THE WEB, AND RESTING ON THE LEDGE OF THE MANIFOLD.**
- 3. ITEM 2, CAP, REQUIRED ONLY IF CAPPING BOOST TAP TUBE.**
- 4. ITEM 3, CLAMP, USED ONLY FOR RUBBER CAP, ITEM 3, ON BOOST TAP TUBE.**
- 5. ITEM 5 MUST BE INSTALLED IF REMOVING PCV HOSE FROM BOOST TAP TO CRANKCASE PCV ASSEMBLY. APPLY TEFLON TAPE ON THREADS BEFORE INSTALLING.**