



INSTALLATION INSTRUCTIONS

57-3023-1
CHEVROLET / GMC / CADILLAC

- Avalanche
2002-2004 V8-5.3L
Silverado 1500HD / Sierra 1500HD
2001-03 & 2005-06 V8-6.0L
Silverado Classic 1500HD / Sierra Classic 1500HD
2007 V8-6.0L
Silverado 2500 / Sierra 2500
1999-2004 V8-6.0L
1999-2000 V8-5.3L
Silverado Classic SS
2007 V8-6.0L
Silverado SS
2003-2004 V8-6.0L
Suburban / Yukon XL
2000-2004 V8-5.3L, 6.0L
2005-2006 V8-6.0L
Tahoe / Yukon
2000-2004 V8-4.8L, 5.3L
Sierra C3
2001 V8-6.0L
Sierra Denali
2002-2004 V8-6.0L
Sierra Classic Denali
2007 V8-6.0L
Yukon Denali, Yukon XL Denali
2001-06 V8-6.0L
Escalade
2002-04 V8-5.3L, 6.0L
Escalade EXT
2002-04 V8-6.0L
Excalade ESV.
2003-04 V8-6.0L

NOTE: This kit was not designed to fit vehicles with a body lift

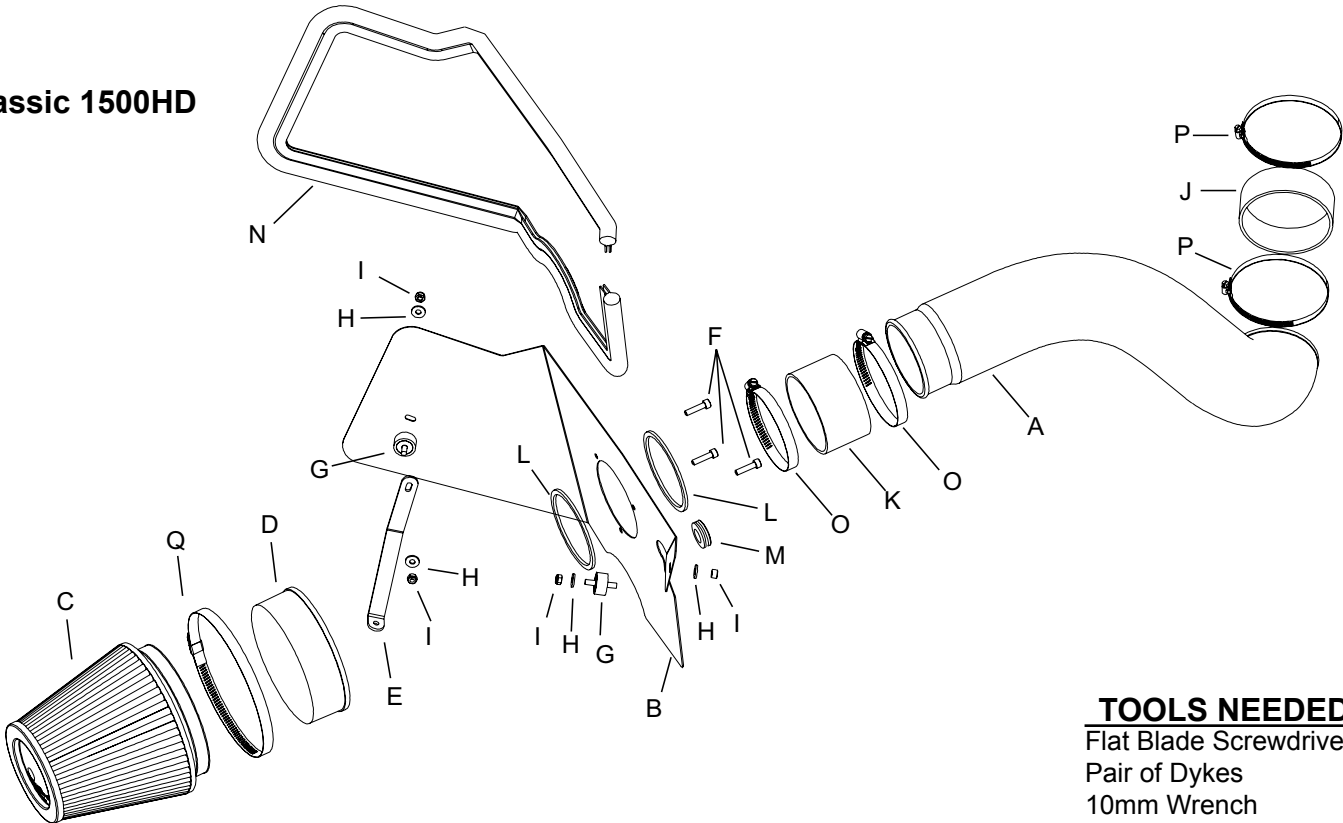

- TOOLS NEEDED:**
Flat Blade Screwdriver
Pair of Dykes
10mm Wrench
4mm Allen Wrench
Drill
1/4" Drill Bit

PARTS LIST:

Description	Qty.	Part#	Description	Qty.	Part#
A Intake Tube	1	08740	J Hose; 4" ID X 1-1/2" L	1	08755
B Heat Shield	1	07417	K Hose;3.75" ID x 2"L	1	08631
C Air Filter	1	RF-1042	L Gasket	2	09033
D Adapter	1	08783	M Grommet	1	08058
E Bracket	1	070822	N Trim Seal 55"L	1	102480
F Allen Bolt	3	08320	O Hose Clamp #60	2	08624
G Rubber Mntd Stud	2	07027	P Hose Clamp #64 MIDI	2	08650
H Flat Washer	4	08275	Q Hose Clamp #104	1	08697
I Nylock Nut	4	07553			

NOTE: FAILURE TO FOLLOW INSTALLATION INSTRUCTIONS AND NOT USING THE PROVIDED HARDWARE MAY DAMAGE THE INTAKE TUBE, THROTTLE BODY AND ENGINE.

TO START:

1. Turn off the ignition and disconnect the negative battery cable.
NOTE: Disconnecting the negative battery cable erases pre-programmed electronic memories. Write down all memory settings before disconnecting the negative battery cable. Some radios will require an anti-theft code to be entered after the battery is reconnected. The anti-theft code is typically supplied with your owner's manual. In the event your vehicles' anti-theft code cannot be recovered, contact an authorized dealership to obtain your vehicles anti-theft code.



2. Disconnect the mass air sensor electrical connection.



3. Loosen the hose clamp on the intake hose at the mass air sensor.



4. Loosen the hose clamp on the intake tube at the throttle body.

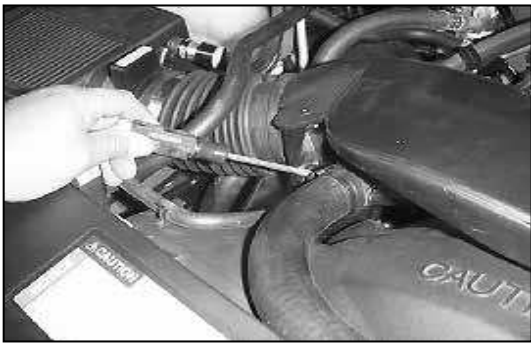

5. Using a flat blade screwdriver, pry the radiator hose retaining clip from the intake tube.



6. Detach the intake hose from the mass air sensor.



7. Detach the intake tube from the throttle body and remove the intake assembly.

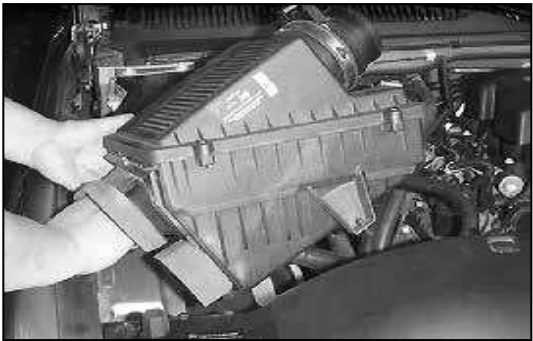

8. Pull firmly upward and remove the airbox.
NOTE: K&N Engineering, Inc., recommends that customers do not discard factory air intake.



9. Loosen the hose clamp and remove the mass air sensor from the airbox.

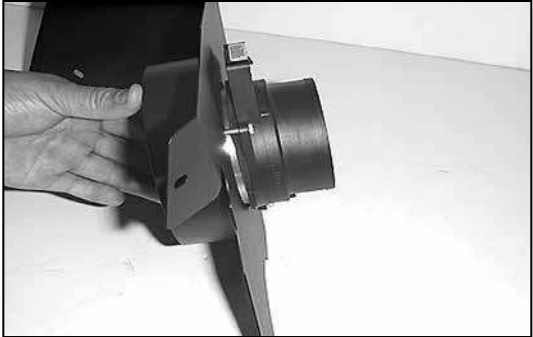

10. Assemble the mass air sensor, heat shield and adapter using the gasket and hardware provided.

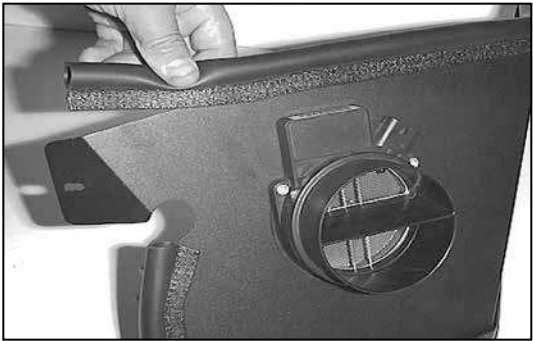

11. Install the trim seal onto the heat shield as shown.
NOTE: Some cutting and trimming may be necessary to achieve best fit.

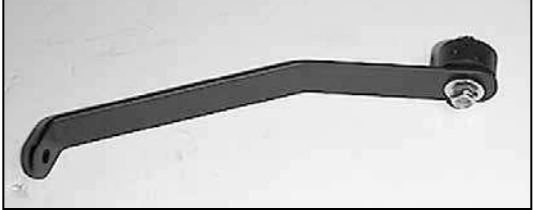

12. Attach the rubber mounted stud to the bracket.
NOTE: Do not tighten completely at this time.



13. Cut out 1/4 of the grommet provided as shown.



14. Install the grommet onto the heat shield.



15. Attach the bracket assembly to the heat shield using the hardware provided.
NOTE: Do not tighten completely at this time.

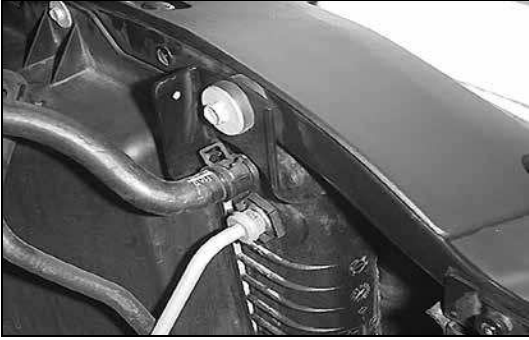

16. Measure over and down 1/2" on the radiator mounting bracket and mark.



17. Using 1/4" drill bit, drill out location marked in the previous step.



18. Attach a rubber mounted stud to the heat shield using the hardware provided.
NOTE: Do not tighten completely at this time.

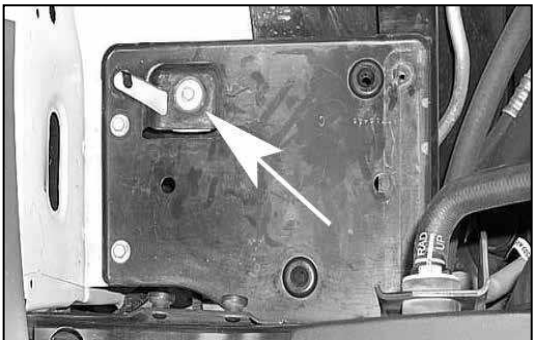

19. Loosen and remove the bolt from the airbox mounting tray.

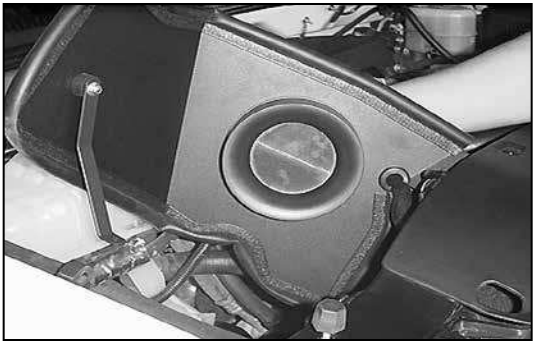

20. Install the heat shield assembly.



21. Secure the bracket to the airbox mounting tray using the bolt removed in step 19.
NOTE: Do not tighten completely at this time.



22. Secure the rubber mounted stud to the radiator mounting bracket.



23. Install the 4"ID silicone hose onto the intake tube.
NOTE: Do not tighten the hose clamps at this time.



24. Install the 3.75"ID silicone hose (08631) onto the intake tube.
NOTE: Do not tighten the hose clamps at this time.



25. Install the intake tube and tighten the hose clamp on the silicone hose at the throttle body.

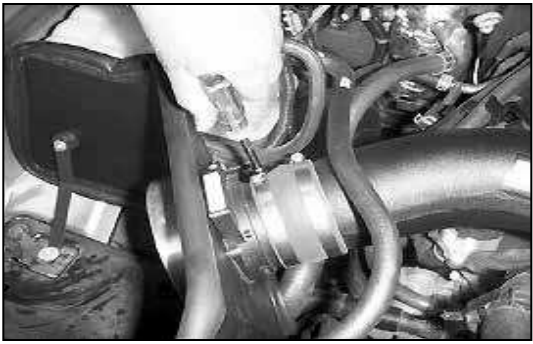

26. Align the intake tube with the mass air sensor and tighten the hose clamp on the silicone hose at the mass air sensor.



27. Align and check the intake tube for clearance, tighten the hose clamp on the silicone hose at the intake tube.



28. Tighten the hose clamp on the silicone hose at the intake tube.

29. Go back and tighten the hardware that mounts the brackets and heat shield. Reconnect the mass air sensor electrical connection.



30. Insert the radiator over flow hose into the grommet on the heat shield.



31. Due to production tolerances it may be necessary to mark the fan shroud as indicated, remove the intake tube and trim the fan shroud.
NOTE: Be sure to cover the throttle body and alternator during this process.



32. Install the air filter and secure with hose clamp.

33. Reconnect the vehicle's negative battery cable. Double check to make sure everything is tight and properly positioned before starting the vehicle.

34. The C.A.R.B. exemption sticker, (attached), must be visible under the hood so that an emissions inspector can see it when the vehicle is required to be tested for emissions. California requires testing every two years, other states may vary.

35. **NOTE:** Most General Motors vehicles have the Vehicle Emissions Certification Information (VECI) label affixed to the air filter box. In order to be compliant with California emissions laws, the label **MUST** remain in the engine compartment. If the Vehicle Emission Control Information label is removed during modification, a new replacement label must be obtained and installed in a readily visible position in the engine compartment. The label shall not be affixed to any equipment which is easily detached from the vehicle. We recommend that the label is affixed to the underside of the hood adjacent to the hood latch. The label is Vehicle Identification Number dependent and can be ordered from the vehicle dealership. In order to receive the proper decal please bring your VIN with you. Failure to have the VECI under the hood may result in failure of a pre-registration smog test.

36. It will be necessary for all K&N® high flow intake systems to be checked periodically for realignment, clearance and tightening of all connections. Failure to follow the above instructions or proper maintenance may void warranty.

ROAD TESTING:

1. Start the engine with the transmission in neutral or park, and the parking brake engaged. Listen for air leaks or odd noises. For air leaks secure hoses and connections. For odd noises, find cause and repair before proceeding. This kit will function identically to the factory system except for being louder and much more responsive.

2. Test drive the vehicle. Listen for odd noises or rattles and fix as necessary.

3. If road test is fine, you can now enjoy the added power and performance from your kit.

4. K&N Engineering, Inc., requires cleaning the intake system's air filter element every 100,000 miles. When used in dusty or off-road environments, our filters will require cleaning more often. We recommend that you visually inspect your filter once every 25,000 miles to determine if the screen is still visible. When the screen is no longer visible some place on the filter element, it is time to clean it. To clean and re-oil, purchase our filter Recharger® service kit, part number 99-5050 or 99-5000 and follow the easy instructions.

50-STATE STREET LEGAL

 CARB EXEMPT 

* FREE K&N® decal To register your warranty, please see us online at knfilters.com/register. FREE K&N® decal *